

LSR - Phelps Lake Loop

Grand Teton National Park

PO Drawer 170
Moose, WY 83102

For Emergencies - dial 911
or Teton Interagency Dispatch (307) 739-3301

Please practice Minimum Impact Usage.

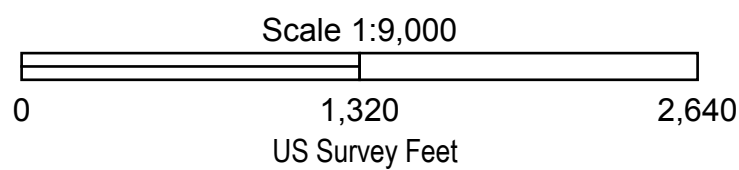

The graphic style for the LSR Trails include red dots spaced .25 miles apart. The .25 mile distance dots begin at the Interpretive Center Trailhead. The route goes clockwise around Phelps Lake. Red mileage distances are given between red stars - waypoints.

LSR - Phelps Lake Loop

interval	mileage	waypoint
0.00	0.00	LSR Intrepretive Center
0.10	0.10	Lake Creek - Woodland Jct
0.50	0.60	Road Crossing
0.10	0.70	Aspen Ridge Tr Jct
0.80	1.50	Phelps Lake
0.60	2.10	Huckleberry Pt Jct
0.95	3.05	Valley Trail Jct
0.45	3.50	Valley/Death Canyon Tr Jct
1.80	5.30	Boulder Ridge Jct (north)
0.10	5.40	Woodland Trail Jct
0.40	5.80	Boulder Ridge Jct (south)
0.35	6.15	Road Crossing
0.25	6.40	Lake Creek - Woodland Jct
0.10	6.50	LSR Intrepretive Center

NAD27 CONUS Datum
Universal Transverse Mercator Zone 12
On 09/05/2014 the magnetic declination is +11.7° changing by -0.15° per year

40 feet contour intervals

- Legend**
- LSR - Phelps Lake Trails
 - Other Park Trails
 - Parking
 - Interpretive Center
 - Restrooms
 - Trailhead
 - Waypoint
 - Mileage

cloudhiking.com
all rights reserved