

Montgomery Bell State Park

1020 Jackson Hill Road
Burns, TN 37029

Park Office - 615-797-9052
Dickson County Emergency - 911

The Montgomery Bell Trail circles the Park in 10.35 miles. The MB Trail is moderate in grade and may be hiked as an overnight hike. Registration is required at the Park Office. The MB Trail may also be hiked in sections using the Creech Hollow Trail as the divider. The East and West Loops are about 7 miles each. There are numerous other trails in the Park including the Wildcat, Ore Pit Loop, and Spillway trails.

Please Practice Minimum Impact Usage

- Park Office
- Parking Area
- Trailhead
- Restrooms
- Sleeping Shelter
- Waypoints
- Mileage
- MB Trail
- Water
- Picnic Area
- Inn and Restaurant
- Golf Course
- Cabin
- Playground
- Park Building
- Other Park Trails

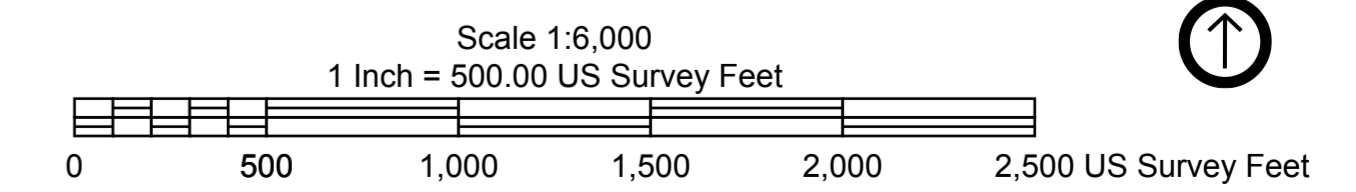

On 11/27/2012 the magnetic declination is -3.0° changing by -0.10° per year
NAD27 CONUS Datum Universal Transverse Mercator Zone 16

cloudhiking.com
all rights reserved